

YELLOWSTONE HALL RESIDENTS LIFE FLOORING

MSU - PLANNING,
DESIGN & CONSTRUCTION
MONTANA STATE UNIVERSITY
BOZEMAN, MONTANA

DRAWN BY:	Author	
REVIEWED BY:	Checker	
REV.	DESCRIPTION	DATE

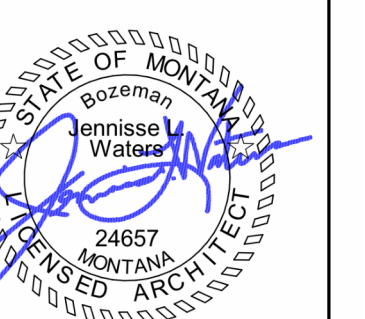

PPA# 24-1197

SHEET TITLE
SECOND FLOOR PLAN -
DEMO AND NEW

SHEET
A1.00

DATE
03/11/25

FLOORING LEGEND

- CARPET
- LVT

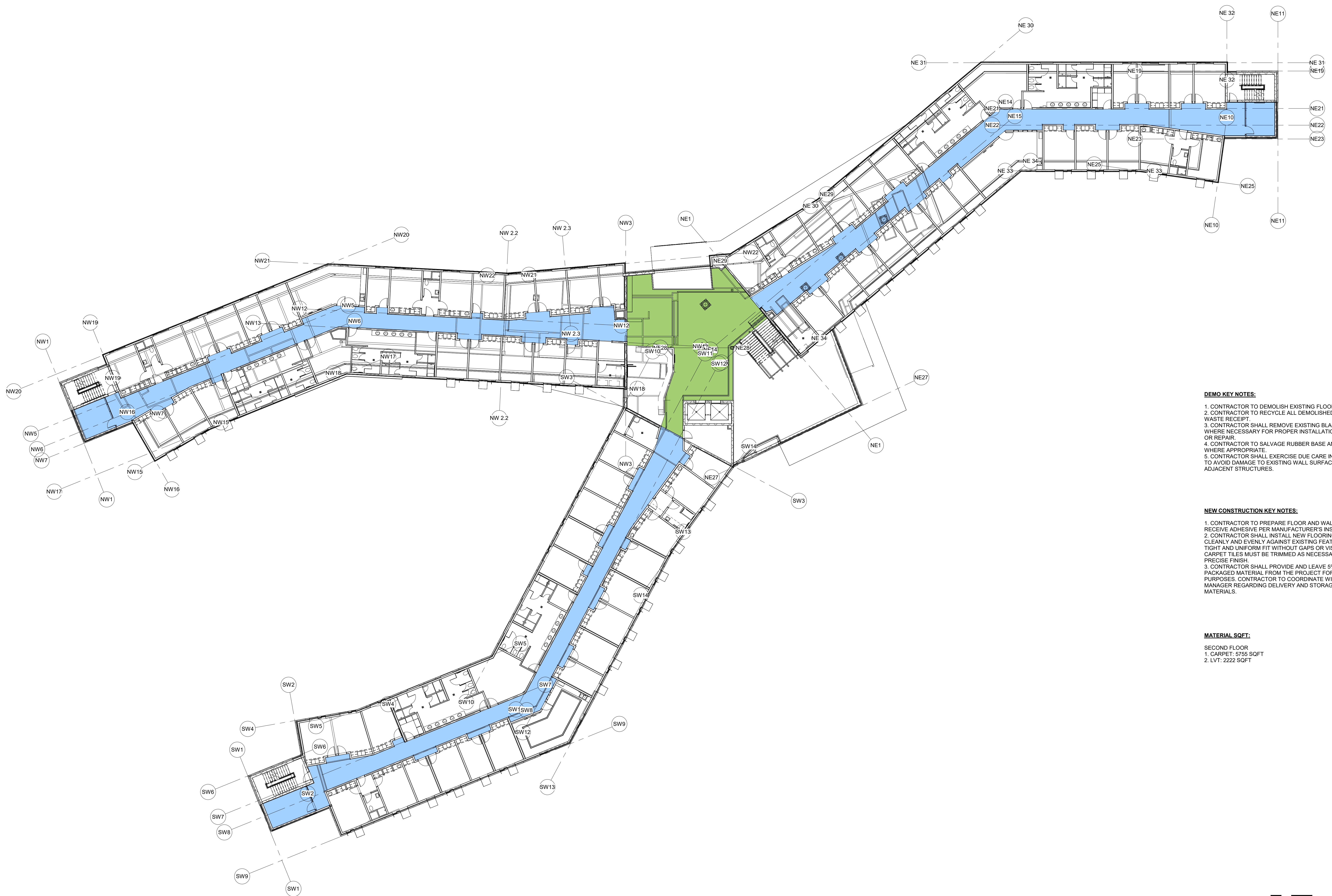

DEMO KEY NOTES:

1. CONTRACTOR TO DEMOLISH EXISTING FLOORING PER DRAWING SET.
2. CONTRACTOR TO RECYCLE ALL DEMOLISHED CARPET AND PROVIDE WASTE RECEIPT.
3. CONTRACTOR SHALL REMOVE EXISTING BLACK RUBBER BASE ONLY WHERE NECESSARY FOR PROPER INSTALLATION OF NEW FLOORING OR REPAIR.
4. CONTRACTOR TO SALVAGE RUBBER BASE AND FLOOR TRANSITIONS WHERE APPROPRIATE.
5. CONTRACTOR SHALL EXERCISE DUE CARE IN EXECUTING ALL WORK TO AVOID DAMAGE TO EXISTING WALL SURFACES, FINISHES, AND ADJACENT STRUCTURES.

NEW CONSTRUCTION KEY NOTES:

1. CONTRACTOR TO PREPARE FLOOR AND WALL SURFACES TO RECEIVE ADHESIVE PER MANUFACTURER'S INSTRUCTIONS.
2. CONTRACTOR SHALL INSTALL NEW FLOORING MATERIAL TO ABUT CLEANLY AND EVENLY AGAINST EXISTING FEATURES, ENSURING A TIGHT AND UNIFORM FIT WITHOUT GAPS OR VISIBLE TRANSITIONS. CARPET TILES MUST BE TRIMMED AS NECESSARY TO ACHIEVE A PRECISE FINISH.
3. CONTRACTOR SHALL PROVIDE AND LEAVE 5% SURPLUS OF UNCUT PACKAGED MATERIAL FROM THE PROJECT FOR FUTURE MAINTENANCE PURPOSES. CONTRACTOR TO COORDINATE WITH THE MSU PROJECT MANAGER REGARDING DELIVERY AND STORAGE OF SURPLUS MATERIALS.

MATERIAL SQFT:

- SECOND FLOOR
1. CARPET: 5755 SQFT
2. LVT: 2222 SQFT

1 Overall Floor Plan - Level 2
A1.00 1/16" = 1'-0"

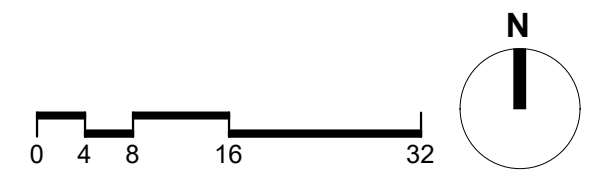

25/03/2025 10:52 AM C:\Users\jwilkes\OneDrive\Documents\24-1197\24-1197-PPA\24-1197-PPA-A1.00.dwg

YELLOWSTONE HALL RESIDENTS LIFE FLOORING

MSU- PLANNING,
DESIGN & CONSTRUCTION
MONTANA STATE UNIVERSITY
BOZEMAN, MONTANA

DRAWN BY:	Author	
REVIEWED BY:	Checker	
REV.	DESCRIPTION	DATE

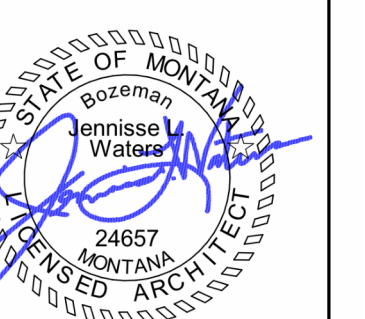

PPA# 24-1197

SHEET TITLE
THIRD FLOOR PLAN -
DEMO AND NEW

SHEET

A1.01

DATE
03/11/25

FLOORING LEGEND

- CARPET
- LVT

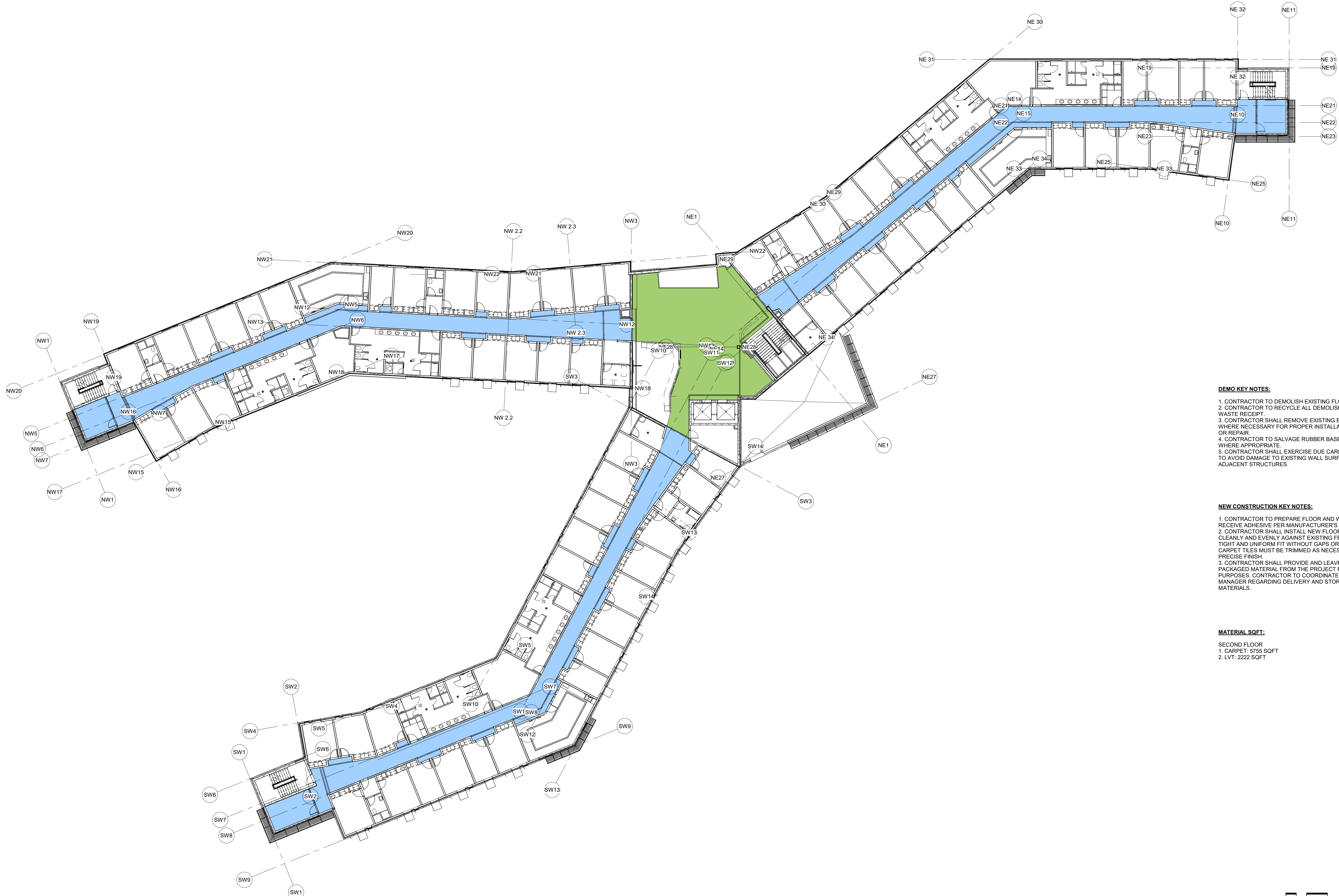

DEMO KEY NOTES:

1. CONTRACTOR TO DEMOLISH EXISTING FLOORING PER DRAWING SET.
2. CONTRACTOR TO RECYCLE ALL DEMOLISHED CARPET AND PROVIDE WASTE RECEIPT.
3. CONTRACTOR SHALL REMOVE EXISTING BLACK RUBBER BASE ONLY WHERE NECESSARY FOR PROPER INSTALLATION OF NEW FLOORING OR REPAIR.
4. CONTRACTOR TO SALVAGE RUBBER BASE AND FLOOR TRANSITIONS WHERE APPROPRIATE.
5. CONTRACTOR SHALL EXERCISE DUE CARE IN EXECUTING ALL WORK TO AVOID DAMAGE TO EXISTING WALL SURFACES, FINISHES, AND ADJACENT STRUCTURES.

NEW CONSTRUCTION KEY NOTES:

1. CONTRACTOR TO PREPARE FLOOR AND WALL SURFACES TO RECEIVE ADHESIVE PER MANUFACTURER'S INSTRUCTIONS.
2. CONTRACTOR SHALL INSTALL NEW FLOORING MATERIAL TO ABUT CLEANLY AND EVENLY AGAINST EXISTING FEATURES, ENSURING A TIGHT AND UNIFORM FIT WITHOUT GAPS OR VISIBLE TRANSITIONS. CARPET TILES MUST BE TRIMMED AS NECESSARY TO ACHIEVE A PRECISE FINISH.
3. CONTRACTOR SHALL PROVIDE AND LEAVE 5% SURPLUS OF UNCUT PACKAGED MATERIAL FROM THE PROJECT FOR FUTURE MAINTENANCE PURPOSES. CONTRACTOR TO COORDINATE WITH THE MSU PROJECT MANAGER REGARDING DELIVERY AND STORAGE OF SURPLUS MATERIALS.

MATERIAL SQFT:

- SECOND FLOOR
1. CARPET: 5755 SQFT
2. LVT: 2222 SQFT

1 Overall Floor Plan - Level 3
A1.01 1/16" = 1'-0"

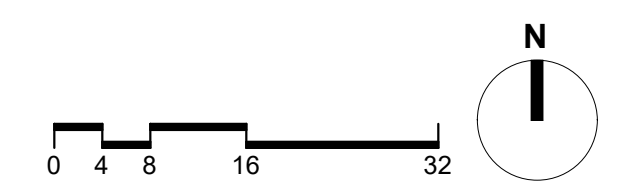

YELLOWSTONE HALL RESIDENTS LIFE FLOORING

MSU - PLANNING,
DESIGN & CONSTRUCTION
MONTANA STATE UNIVERSITY
BOZEMAN, MONTANA

DRAWN BY:	Author	
REVIEWED BY:	Checker	
REV.	DESCRIPTION	DATE

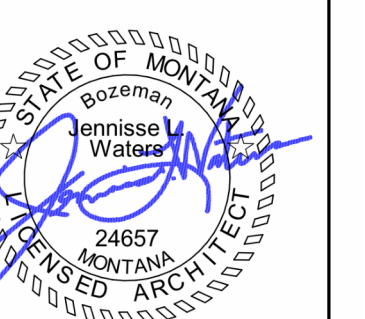

PPA# 24-1197

SHEET TITLE
FOURTH FLOOR PLAN -
DEMO AND NEW

SHEET

A1.02

DATE

03/11/25

FLOORING LEGEND

- CARPET
- LVT

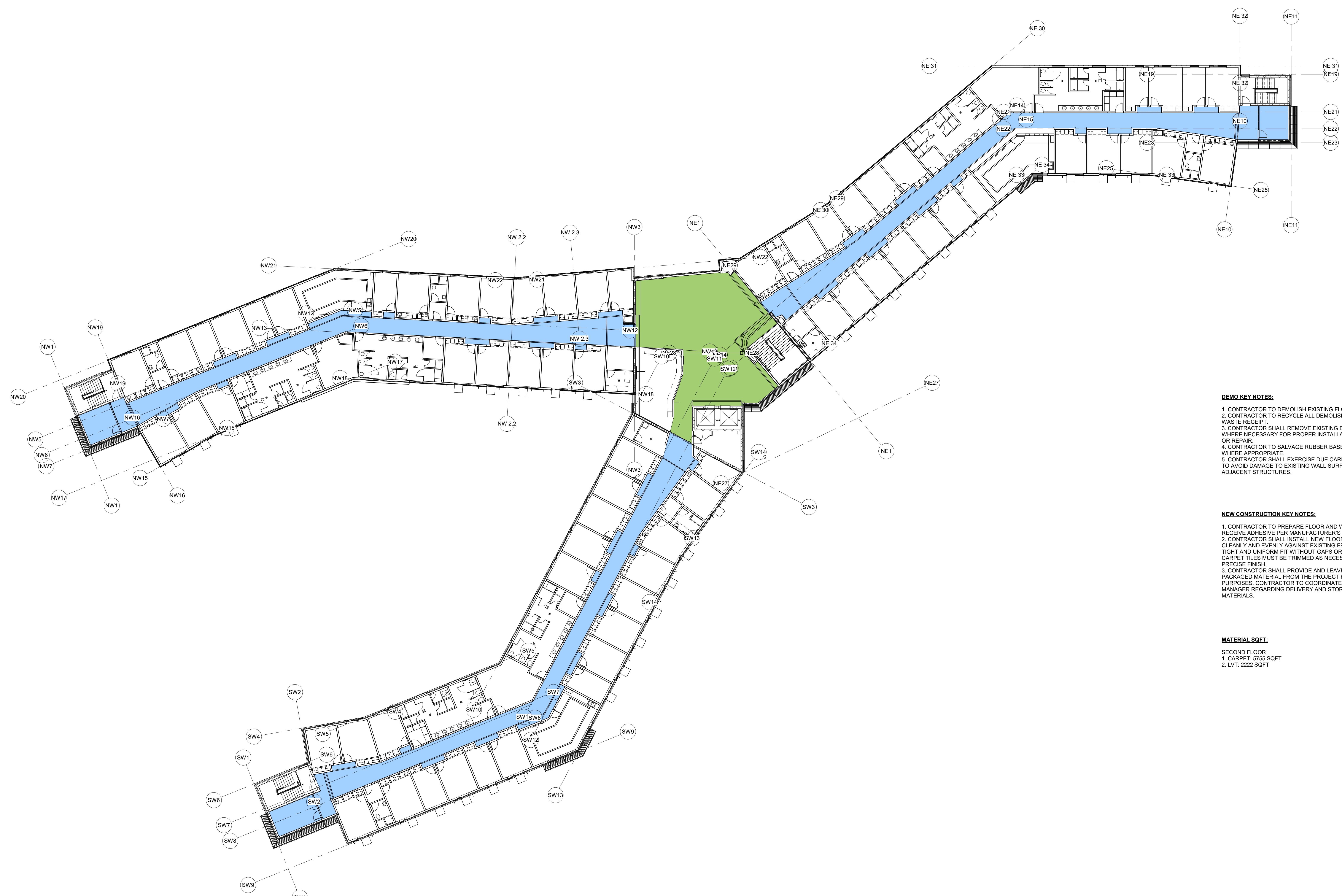

DEMO KEY NOTES:

1. CONTRACTOR TO DEMOLISH EXISTING FLOORING PER DRAWING SET.
2. CONTRACTOR TO RECYCLE ALL DEMOLISHED CARPET AND PROVIDE WASTE RECEIPT.
3. CONTRACTOR SHALL REMOVE EXISTING BLACK RUBBER BASE ONLY WHERE NECESSARY FOR PROPER INSTALLATION OF NEW FLOORING OR REPAIR.
4. CONTRACTOR TO SALVAGE RUBBER BASE AND FLOOR TRANSITIONS WHERE APPROPRIATE.
5. CONTRACTOR SHALL EXERCISE DUE CARE IN EXECUTING ALL WORK TO AVOID DAMAGE TO EXISTING WALL SURFACES, FINISHES, AND ADJACENT STRUCTURES.

NEW CONSTRUCTION KEY NOTES:

1. CONTRACTOR TO PREPARE FLOOR AND WALL SURFACES TO RECEIVE ADHESIVE PER MANUFACTURER'S INSTRUCTIONS.
2. CONTRACTOR SHALL INSTALL NEW FLOORING MATERIAL TO ABUT CLEANLY AND EVENLY AGAINST EXISTING FEATURES, ENSURING A TIGHT AND UNIFORM FIT WITHOUT GAPS OR VISIBLE TRANSITIONS. CARPET TILES MUST BE TRIMMED AS NECESSARY TO ACHIEVE A PRECISE FINISH.
3. CONTRACTOR SHALL PROVIDE AND LEAVE 5% SURPLUS OF UNCUT PACKAGED MATERIAL FROM THE PROJECT FOR FUTURE MAINTENANCE PURPOSES. CONTRACTOR TO COORDINATE WITH THE MSU PROJECT MANAGER REGARDING DELIVERY AND STORAGE OF SURPLUS MATERIALS.

MATERIAL SQFT:

- SECOND FLOOR
1. CARPET: 5755 SQFT
2. LVT: 2222 SQFT

1 Overall Floor Plan - Level 4
A1.02 1/16" = 1'-0"

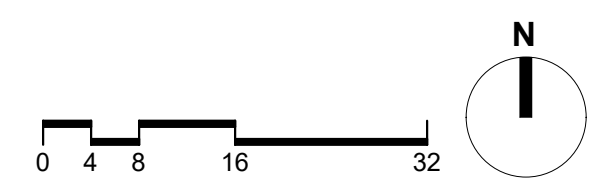

DRAWN BY:	Author	
REVIEWED BY:	Checker	
REV.	DESCRIPTION	DATE

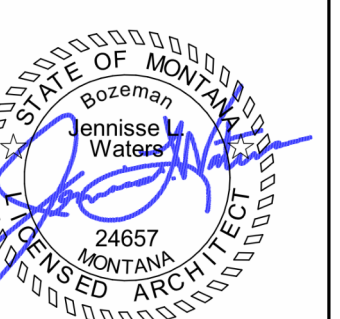

PPA# 24-1197

SHEET TITLE
COVER SHEET

SHEET
G0.00

DATE
03/11/25

YELLOWSTONE HALL RESIDENTS LIFE FLOORING PPA# 24-1197

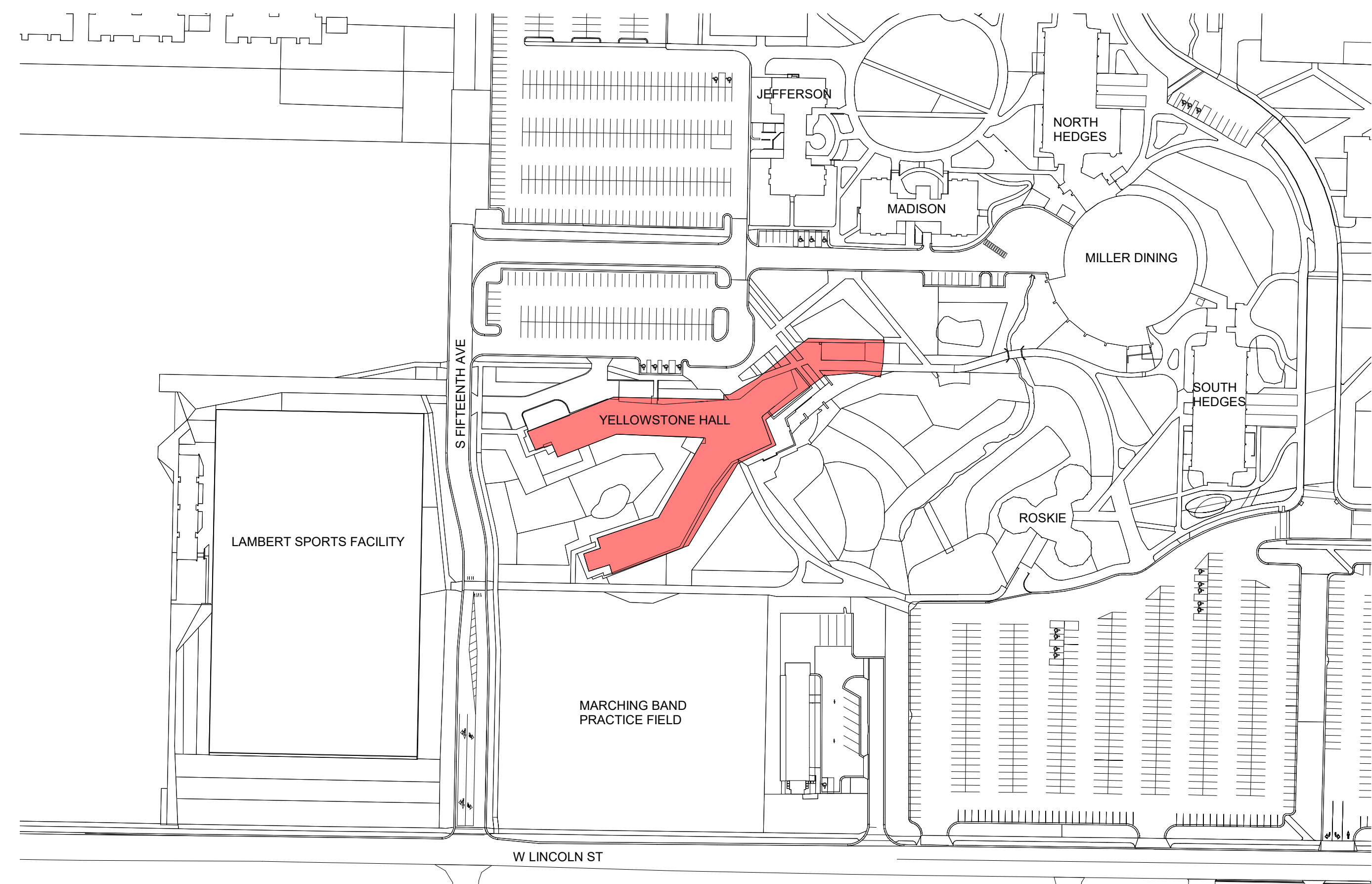

1 VACINITY MAP - YELLOWSTONE HALL IN RED
Scale: 1" = 10'-0"

GENERAL CONDITIONS

1. CONTRACTOR TO FIELD VERIFY ALL EXISTING CONDITIONS PRIOR TO BID SUBMITTAL AND TO NOTIFY MSU PROJECT MANAGER IMMEDIATELY IN WRITING OF ANY DISCREPANCIES.
2. THE CONTRACTOR SHALL PREPARE THE FLOOR IN ACCORDANCE WITH THE SPECIFICATIONS AND STANDARDS REQUIRED BY NEW FLOORING MANUFACTURER TO ENSURE PROPER INSTALLATION PRIOR TO LAYING THE NEW FLOORING.
3. CONTRACTOR TO PROVIDE AND INSTALL NEW FLOORING MATERIAL.
4. CONTRACTOR TO PROVIDE AND INSTALL NEW RUBBER BASE.
5. ALL MATERIALS AND EQUIPMENT SHALL BE DELIVERED AND INSTALLED ON A JUST-IN-TIME BASIS. CONTRACTOR TO COORDINATE TEMPORARY LAYDOWN AREA WITH MSU PROJECT MANAGER IF NEEDED.
6. CONTRACTOR TO PROVIDE AND INSTALL RUBBER REDUCER STRIPS AT ALL DOORWAYS TO REPLACE EXISTING REMOVED DURING DEMOLITION.

PROJECT DESCRIPTION
DEMOLITION AND REPLACEMENT OF EXISTING FLOORING ON THE SECOND, THIRD, AND FOURTH FLOORS OF YELLOWSTONE HALL. YELLOWSTONE HALL IS LOCATED ON THE MONTANA STATE UNIVERSITY BOZEMAN CAMPUS.

OWNER CONTACT INFORMATION
MONTANA STATE UNIVERSITY FACILITIES MANAGEMENT
PO BOX 172760
BOZEMAN, MONTANA 59717

PDC CONTACT
JENNISSE WATERS
JENNISSE.WATERS@MONTANA.EDU

PROJECT MANAGER
KIRK BIERSCHENK
(406) 994-7533
KIRK.BIERSCHENK@MONTANA.EDU

SHEET LIST

- G0.00 COVER SHEET
- A1.00 SECOND FLOOR PLAN - DEMO AND NEW
- A1.01 THIRD FLOOR PLAN - DEMO AND NEW
- A1.02 FOURTH FLOOR PLAN - DEMO AND NEW

MATERIAL SPECIFICATIONS

USE UZIN PE414 PRIMER FOR GYPCRETE
FLOAT GYPCRETE WITH ARDEX FEATHER FINISH

CARPET

MANUFACTURER: SHAW CONTRACT
PRODUCT LINE: DISTORT TILE
PRODUCT NUMBER: 51127
COLORWAY: INTERRUPT
COLOR NUMBER: 26505
SIZE: 18 IN X 36 IN
BACKING: ECOWORX TILE
CONSTRUCTION: MULTILEVEL PATTERN LOOP
ADHESIVE OPTIONS: LOKDOOT, 3000 CARPET TILE 4 GALLON, 3000 CARPET TILE 1 GALLON, 4151 MULTI-USE CARPET TILE 4 GALLON, 5000 CARPET TILE 1 GALLON, LOWWORK ADHESIVE TA85, 3000 INDOOR OUTDOOR CARPET TILE 4 GALLON, 5000 CARPET TILE 4 GALLON

LVT

MANUFACTURER: SHAW CONTRACT
PRODUCT LINE: SOLITUDE
PRODUCT NUMBER: 0648V
COLORWAY: MINK
COLOR NUMBER: 28720
SIZE: 6 IN X 48 IN | 15 CM X 122 CM X 0.197 IN | 5MM
BACKING: HEAVY COMMERCIAL LUXURY VINYL TILE WITH FIBERGLASS
SHAPE: SQUARED EDGE
ADHESIVE OPTIONS: ADHESIVE OPTIONS: S150-85 RESILIENT TILE SPRAY, 4200 RESILIENT TILE 4 GALLON, 2200 SEMI-WET RESILIENT 4 GALLON PAUL, 2200 SEMI-WET RESILIENT 1 GALLON PAUL, 4151 MULTI-USE PREMIUM 4 GALLON